



AT WAI'ANAE BOAT HARBOR

CRUISE EVENTS

11:45 a.m. **Aloha and welcome aboard!** As we get underway, our crew will give a snorkel safety briefing and introduction to some of the marine life you might encounter.

Throughout the cruise, enjoy dolphin watching and 360° views of the Wai'anae coastline on the observation deck. The Captain will be sure to announce sightings and share interesting insights. Also feel free to talk to our onboard Naturalists, participate in our *keiki* (child) program or listen to our Captain's narration.

12:00 p.m. As you enjoy lunch, Dolphin Star® takes you to the best snorkeling spots along the Wai'anae coastline where you'll view beautiful coral formations and abundance of marine life such as Bluespine Unicornfish, Stripedbelly Pufferfish and Hawaiian Green Sea Turtles. Our trained divers will lead you on snorkel tours and be available to assist you in any way.

2:30 p.m. On the return trip to the pier, quench your thirst with after-snorkel refreshments including Dolphin Star®'s Original Blue Dolphin Cocktail, fresh pineapple and more.

3:00 p.m. **Mahalo** for joining us today! Please relax as our crew prepares the ship for disembarking.

PHOTOS & SOUVENIRS

Memory Photo in Logo Paper Jacket, no obligation to purchase.....\$20.00

Dolphin Star® VIP Card: Present on your next Dolphin Star® Cruise for a special gift.



STAR OF HONOLULU
CRUISES & EVENTS



WELCOME

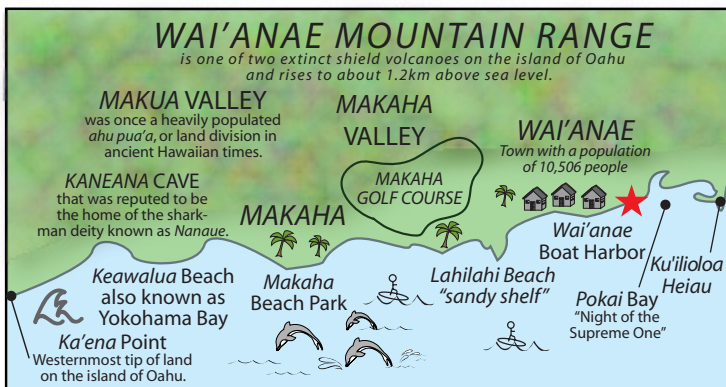

BEVERAGE MENU

Alcoholic and (V) non-alcoholic cocktails are \$8.00 each;
soft drinks are \$4.00 each.

TROPICALS & MORE

Bloody Mary, Mai Tai, Beer
Blue Dolphin (V)

SOFT DRINKS

Coca-Cola, Diet Coke,
Lemon-Lime, Pineapple Juice

CREATE-YOUR OWN GOURMET BURGER® BBQ LUNCH

Freshly Grilled Onboard
Premium All Beef Hamburgers

Selection of Buns
Freshly Baked *Taro* or Kaiser Buns

Gourmet Fixings
Grilled Pineapple*, Avocado*,
Kamuela Vine Ripened Tomato*,
Purple Onion*, Kula Lettuce*

Cheeses
Cheddar, Swiss, Pepper Jack

Sauces
Teriyaki, Spicy BBQ,
Tomato Ketchup, Mayonnaise, Mustard

Trio of Potato Chips
Taro, Maui Style, Sweet Potato

Dessert
Homemade Chocolate Brownies

* Vegan Selections

Consuming raw or undercooked meats, poultry, seafood,
shellfish or eggs may increase your risk of foodborne illness.

After-Snorkel Refreshments

Fresh Pineapple*
Maui Style Potato Chips
Homemade Chocolate Brownies
Dolphin Star®'s Original Blue Dolphin Cocktail

ABOARD

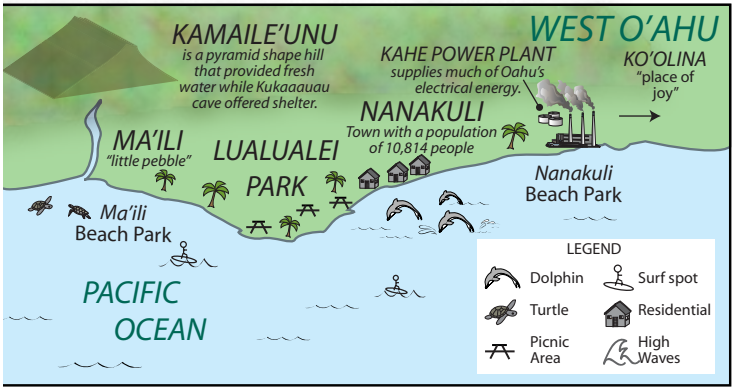

HOW TO SIGHT DOLPHINS

Whenever dolphins or other marine life are sighted, our Captain will make an announcement using a clock system.

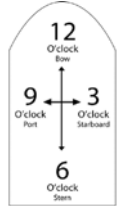

DOLPHIN FACTS

DOLPHINS are cetaceans, which are not fish but air-breathing, warm-blooded mammals that nurse their young. Dolphins are closely related to whales and porpoises.

HAWAIIAN DOLPHINS are unique in that they have not been hunted like others in the Pacific, making them less afraid of humans and boats. Now and in old times, Hawaiians use dolphins to guide them. The three types of dolphins that you are most likely to see are the Hawaiian Spinner (150lb.), Spotted (200+lb.) and Bottlenose (700lb.).

SENSES: Most dolphins have acute eyesight, both in and out of the water. Hearing is superior to that of humans and used for echolocation. Their sense of touch is also well-developed. They have no sense of smell, but they can taste and do show preferences for certain kinds of fish.

COMMUNICATION: Dolphins communicate with sounds. When observing them you may hear clicks, whistles and other sounds.

BEHAVIOR: Dolphins feed on fish, shrimp and squid in deeper waters at night. During the day they rest, play and socialize.

LIFE: The female gestation period is about 10.5 months. A dolphin's lifespan is estimated to be about 20 years.



Dolphin Guaranteed or receive a free return "Dolphin Check" until a dolphin is sighted (meal, transportation and afternoon snorkel optional).

IMPORTANT INFORMATION

Medical / Shipboard Emergencies

Our Captain and crew are trained in first aid and CPR. Please notify them if you are in need of medical assistance. In the unlikely event of a shipboard emergency, please remain seated and wait for safety instructions. The diagrams below illustrate how to put on a life jacket. Life jackets are located beneath perimeter seating.

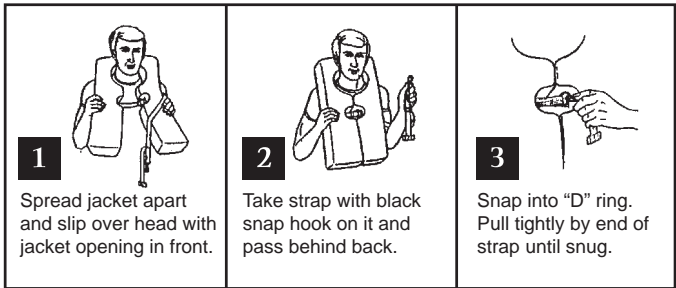

Safety is #1

Handrails along stairways and decks are provided for your safety. Handrails are not for climbing or sitting. Please watch your step for changes in floor level and saltwater mist on decks.

No Smoking

For the comfort and health of other passengers, smoking is prohibited on the Dolphin Star®.

Hawaii State Liquor Law

Alcoholic beverages can only be served to guests 21 years and older. A photo I.D. is required. Alcoholic beverages are prohibited from being carried off the ship.

Protect Our Ocean and Marine Life

Receptacles are provided throughout the ship for disposal of waste. Please do not throw anything overboard. We observe NOAA regulations by operating at the cruising speed shown to be safe for marine mammals and we do not use sonar for it may be harmful to marine life. We do not aggressively seek dolphins.

About the Dolphin Star®

The eco-friendly Dolphin Star® (Hoku Nai'a) is a 149-passenger 2-deck catamaran, custom built for dolphin watching and snorkeling in paradise! The 65' vessel minimizes emissions with EPA compliant main engines, hybrid power generator, GPS, autopilot and radar. It also has a 360° observation deck, wrap-around deck, dining area, bar, restrooms and BBQ and swimming facilities.



STAR OF HONOLULU™
CRUISES & EVENTS

Premier Cruise since 1957®

Thank you for choosing
Dolphin Star®!

If you enjoyed your experience,
we would appreciate
your review at
Dolphin-Star.com/TripAdvisor.

Stay connected with us and
share your photos on
Facebook (@DolphinStarCruises),
Instagram (@DolphinStarHI)
and #DolphinStarHI.

